

Manual hose reels

AVVOLGITUBO MANUALI



Swivel joint side in the standard version
Lato giunto nella versione standard



Handle side in the standard version
Lato maniglia nella versione standard

EN Manual hose reels suitable for the distribution of fluids such as diesel fuel, air, water, oil and grease at different pressure and temperature conditions for hoses having a maximum diameter of 1". The parts in contact with the fluid have metal details and high-quality gaskets. Standard: foldable handle with safety system, swivel joint and adjustable clutch. Optional: side arms complete with 4-rollers hose guide and rotation locking pusher.

FR Enrouleurs manuels adaptés pour distribuer des fluides tels que diesel, air, eau, huile, graisse à différentes pressions et températures pour des tuyaux avec diamètre jusqu'à 1". Composants en contact avec le fluide constitués de pièces métalliques et de joints de haute qualité. De série: poignée pliable avec système de sécurité, raccord

tournant et embrayage réglable. En option: bras latéraux complets avec guide-tuyau à 4 rouleaux et poussoir de blocage de la rotation.

DE Schlauchaufroller zur Abgabe von versch. Flüssigkeiten, wie z.B. Diesel-Kraftstoff, Luft, Wasser, Öl und Fett mit bis zu 1" Schlauchdurchmesser. Teile mit Kontakt von Flüssigkeiten aus spez. Metallen und Dichtungen hoher Qualität. Serienmäßig: klappbarer Griff mit Sicherheitssystem, Drehgelenk und einstellbare Kupplung. Optional: Seitenarme komplett mit 4-Rollen-Schlauchführung und Drücker mit Rotationssperre.

ES Enrolladores manuales ideados para distribuir fluidos como diesel, aire, agua, aceite y grasa con diversas condiciones de

presión y temperatura con manguera de hasta 1" de diámetro. Componentes en contacto con el fluido constituidos por partes metálicas y guarniciones de alta calidad. Estándar: manija plegable con sistema de seguridad, rotula giratoria y embrague regulable. Opcional: brazos laterales completos con guía de manguera de 4 rodillos y empujador de bloqueo de rotación.

IT Avvolgitubo manuali adatti per distribuire fluidi quali gasolio, aria, acqua, olio, grasso a diverse pressioni e temperature per tubi aventi diametro massimo 1". Parti a contatto con il fluido costituite da particolari metallici e guarnizioni di elevata qualità. Di serie: maniglia ripiegabile dotata di sistema di sicurezza, giunto girevole e frizione regolabile. Optional: bracci laterali completi di guida tubo a 4 rulli e spintore bloccaggio rotazione.

STANDARD FOR MOD. H-HL-HM-HB



Manually operated **safety system** that prevents the handle rotation during the unwinding of the hose

Sistema di sicurezza ad azionamento manuale che evita la rotazione della maniglia durante lo svolgimento del tubo

**Foldable handle/
Maniglia ripiegabile**



Adjustable clutch: allows to adjust the rotation speed of the drum during the unwinding of the hose

Frizione regolabile: permette di regolare la velocità di rotazione del tamburo durante lo svolgimento del tubo

Metal **swivel joint** with high quality gaskets

Giunto girevole metallico con guarnizioni di elevata qualità



OPTIONAL FOR MOD. H-HL-HM-HB



**Rotation locking pusher/
Spintore bloccaggio rotazione**
Code **0803** for mod. H-HL-HM-HB

Allows to lock the drum rotation. Recommended in environments with vibrations (trucks, industrial machinery, ...)

Optional, supplied in separate packaging and not assembled on the hose reel

Permette il bloccaggio della rotazione del tamburo. Consigliato in ambienti con vibrazioni (camion, macchinari industriali, ...) Optional fornito in imballo separato e non montato sull'avvolgitubo

**Side arms complete with 4-roller hose guide
Bracci laterali completi di guida tubo a 4 rulli**

Code **KB4RH** for mod. H

Code **KB4RHL** for mod. HL

Code **KB4RHM** for mod. HM

Code **KB4RHB** for mod. HB

Optional, supplied in separate packaging and not assembled on the hose reel
Optional fornito in imballo separato e non montato sull'avvolgitubo



H-HL-HM-HB manual RAL 7040

GALVANIZED AND POWDER COATED STRUCTURE / STRUTTURA ZINCATA E VERNICIATA

ø 445 mm (mod. H-HL-HM)
ø 550 mm (mod. HB)

optional [page 88-93](#)

0803

KB4RH/HL/HM/HB

0835K

only for / per
HL200110ST
HM200120ST
HB200130ST



Hose reels capacity (m) / Capacità degli avvolgitubo (m)

| Ø ext. Hose (mm) | A (1/4"-5/16"-3/8") | | | | B (1/2"-5/8") | | C (3/4") 20 bar/290 psi | | D (1") 20 bar/290 psi | E (3/4"-1") 60 bar/870 psi | |
|------------------|---------------------|-----|-----|-----|---------------|----|----------------------------|----|--------------------------|-------------------------------|----|
| | 12 | 14 | 16 | 18 | 20 | 23 | 25 | 27 | 35 | 27 | 35 |
| H | 60 | 50 | 30 | 25 | 20 | 15 | - | - | - | - | - |
| HL | 90 | 80 | 45 | 40 | 35 | 25 | 22 | 20 | 10 | - | - |
| HM | 175 | 130 | 90 | 60 | 50 | 45 | 40 | 30 | 20 | 25 | 15 |
| HB | 250 | 210 | 120 | 100 | 90 | 70 | 65 | 60 | 35 | 55 | 30 |

Variable indicative values according to the type of hose / Valori indicativi variabili in base alla tipologia di tubo

H

Dimensions (mm) / Dimensioni (mm)

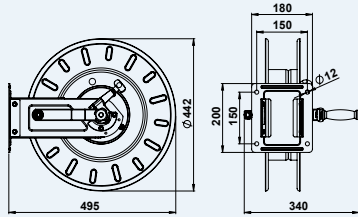

HL

Dimensions (mm) / Dimensioni (mm)

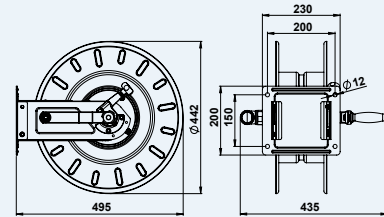

HM

Dimensions (mm) / Dimensioni (mm)

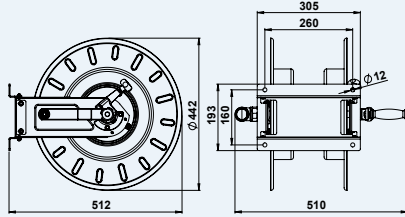

HB

Dimensions (mm) / Dimensioni (mm)

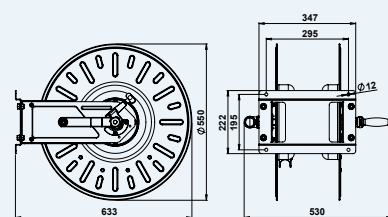

Hose reels models H-HL-HM-HB without hose / Avvolgitubo modelli H-HL-HM-HB senza tubo

| Fluid Fluido | Max. pressure Pressione max. | Code Codice | Inlet (Bsp) Entrata (Gas) | Outlet Uscita | Capacity Capacità (Table page 48) | Weight (kg) Peso (kg) | | | |
|--|---------------------------------|----------------|------------------------------|------------------|---|--------------------------|-----------|--------------|----|
| Air/Aria Water/Acqua Oil/Olio | 60 bar/870 psi | H603830ST | 3/8" F | G 3/8" M | A 1/4"-5/16"-3/8" | 9 | | | |
| | | HL603845ST | 3/8" F | G 3/8" M | | 10 | | | |
| | | HM603890ST | 3/8" F | G 3/8" M | | 11 | | | |
| | | HB6038120ST | 3/8" F | G 3/8" M | | 15 | | | |
| Grease/Grasso Water/Acqua 150°C | 400 bar/5800 psi | H4V3825ST | 3/8" F | G 3/8" M | | B 1/2"-5/8" | 9 | | |
| | | HL4V3840ST | 3/8" F | G 3/8" M | | | 10 | | |
| | | HM4V3860ST | 3/8" F | G 3/8" M | | | 11 | | |
| | | HB4V38100ST | 3/8" F | G 3/8" M | | | 15 | | |
| Air/Aria Water/Acqua 150°C Oil/Olio | 400 bar/5800 psi | H4V1220ST | 1/2" M | G 1/2" M | | | C 3/4" | 9 | |
| | | HL4V1235ST | 1/2" M | G 1/2" M | | | | 10 | |
| | | HM4V1250ST | 1/2" M | G 1/2" M | | | | 11 | |
| | | HB4V1290ST | 1/2" M | G 1/2" M | | | | 15 | |
| Air/Aria Water/Acqua 100°C Diesel fuel/Gasolio | 20 bar/290 psi | HL203420ST | 1" F | Ø 19 mm | D 1" | | | 10 | |
| | | HM203430ST | 1" F | Ø 19 mm | | | | 11 | |
| | | HB203460ST | 1" F | Ø 19 mm | | | | 15 | |
| | | HL200110ST | 1" F | Ø 25 mm | | | | E 3/4"-1" | 10 |
| | | HM200120ST | 1" F | Ø 25 mm | | 11 | | | |
| | | HB200135ST | 1" F | Ø 25 mm | | 15 | | | |
| Oil/Olio | 60 bar/870 psi | HM600115ST | 1" M | G 1" M | | E 3/4"-1" | | | 11 |
| | | HB600130ST | 1" M | G 1" M | | | | | 15 |